

Guide rail clamp (for round rails) - Part. Q83
Morsetto portaguide (per guide tonde) - Part. Q83

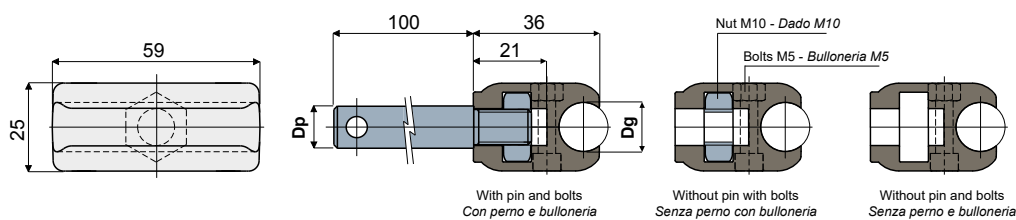

Dp Pin diameter Diametro perno (mm)	Dg Rail diameter Diametro guida (mm)	With pin and bolts Con perno e bulloneria	
		Type Tipo	Code Codice
12	8	Q83A	CPA00179
	10	Q83B	CPA00180
	12	Q83C	CPA00181
	14	Q83D	CPA00182
14	8	Q83E	CPA00183
	10	Q83F	CPA00184
	12	Q83G	CPA00185
	14	Q83H	CPA00186
16	8	Q83I	CPA00187
	10	Q83L	CPA00188
	12	Q83M	CPA00189
	14	Q83N	CPA00190

Dg Rail diameter Diametro guida (mm)	Without pin with bolts Senza perno con bulloneria	
	Type Tipo	Code Codice
8	Q83O	CPA00191
10	Q83P	CPA00192
12	Q83Q	CPA00193
14	Q83R	CPA00194

Dg Rail diameter Diametro guida (mm)	Without pin and bolts Senza perno e bulloneria	
	Type Tipo	Code Codice
8	Q83S	CPA00195
10	Q83T	CPA00196
12	Q83U	CPA00197
14	Q83V	CPA00198

UK MATERIALS: Clamp made of reinforced polyamide black colour; pin, bolts and nuts made of stainless steel AISI 304.

FEATURES: Supplied with or without support pin and with or without bolts and nuts.

IT MATERIALI: Morsetto in poliammide rinforzata colore nero; perno, dado e bulloneria in acciaio inox AISI 304.
CARATTERISTICHE: Fornito completo con perno di sostegno, senza perno, e senza bulloneria.

Guide rail clamp (for trapezoidal rails) - Part. Q84
Morsetto portaguide (per guide trapezoidali) - Part. Q84

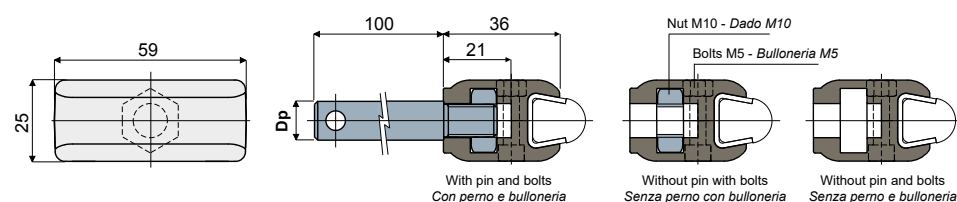

Rail for this type of clamp
 Guide supportate

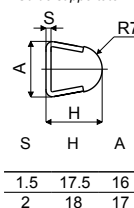

Dp Pin diameter Diametro perno (mm)	With pin and bolts Con perno e bulloneria		Without pin with bolts Senza perno con bulloneria		Without pin and bolts Senza perno e bulloneria	
	Type Tipo	Code Codice	Type Tipo	Code Codice	Type Tipo	Code Codice
12	Q84A	CPB00183				
14	Q84B	CPB00184	Q84D	CPB00186	Q84E	CPB00187
16	Q84C	CPB00185				

UK MATERIALS: Clamp made of reinforced polyamide black colour; pin, bolts and nuts made of stainless steel AISI 304.

FEATURES: Supplied with or without support pin and with or without bolts and nuts. With this item it is possible to use thickness 1,5 and 2 mm guides: Part.T53, T54 T77, Q18, Q19, Q20, Q46, Q69, Q85, C14.

IT MATERIALI: Morsetto in poliammide rinforzata colore nero; perno, dado e bulloneria in acciaio inox AISI 304. **CARATTERISTICHE:** Fornito completo con perno di sostegno, senza perno, e senza bulloneria. Il particolare consente l'utilizzo di guide con spessore 1,5 e 2 mm.: Part. T53, T54 T77, Q18, Q19, Q20, Q46, Q69, Q85, C14.

Guide rail clamp (for rectangular rails) - Part D90
Morsetto portaguide (per guide rettangolari) - Part. D90

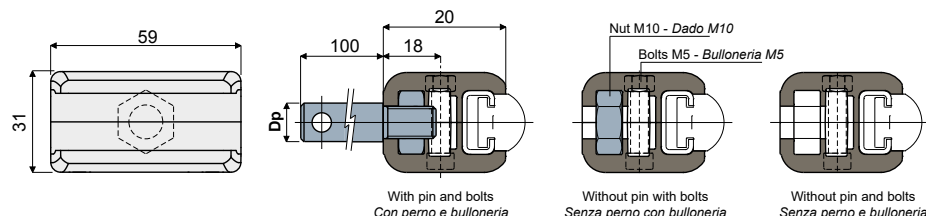

Rail for this type of clamp
 Guide supportate

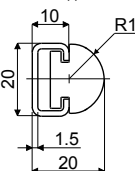

Dp Pin diameter Diametro perno (mm)	With pin and bolts Con perno e bulloneria		Without pin with bolts Senza perno con bulloneria		Without pin and bolts Senza perno e bulloneria	
	Type Tipo	Code Codice	Type Tipo	Code Codice	Type Tipo	Code Codice
12	D90A	CP000192				
14	D90B	CP000193	D90D	CP000195	D90E	CP000196
16	D90C	CP000194				

UK MATERIALS: Clamp made of reinforced polyamide black colour; pin, bolts and nuts made of stainless steel AISI 304.

FEATURES: Supplied with or without support pin. To be used for the support of the product guide rail Part.T73.

IT MATERIALI: Morsetto in poliammide rinforzata colore nero; perno, dado e bulloneria in acciaio inox AISI 304.
CARATTERISTICHE: Fornito assemblato e completo con perno di sostegno, senza perno, e senza bulloneria. Utilizzato come sostegno delle guide laterali tonde Part.T73.