

VIB 弹性组件 型号: AC-P / Elastic Components VIB Type: AC-P

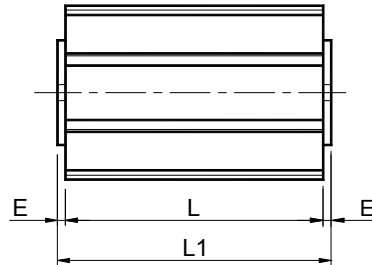

型号 Type	编号 N°	A	B	D	E	F	G	H	L	L1 ^{+0.0/-0.3}	在不同角度 β 的扭矩 Q 以 Nm 表示 Torque Q in Nm at β						重量 Weight in kg
											5°	10°	15°	20°	25°	30°	
AC-P 20 x 25	RE020215	15	5 ^{+0.50/+0.00}	36 ^{+0.30/+0.00}	2.5	10 ±0.2	5	2.5	25	30	0.7	1.6	2.5	3.8	5.4	7.8	0.05
AC-P 20 x 40	RE020216	15	5 ^{+0.50/+0.00}	36 ^{+0.30/+0.00}	2.5	10 ±0.2	5	2.5	40	45	1.1	2.5	4.0	6.1	8.7	12.5	0.09
AC-P 20 x 60	RE020217	15	5 ^{+0.50/+0.00}	36 ^{+0.30/+0.00}	2.5	10 ±0.2	5	2.5	60	65	1.6	3.8	6.0	9.2	13.0	18.8	0.12
AC-P 30 x 30	RE020220	18	6 ^{+0.50/+0.00}	45 ^{+0.40/+0.00}	2.5	12 ±0.3	5	2.5	30	35	1.8	4.2	7.0	10.5	14.3	19.5	0.12
AC-P 30 x 50	RE020221	18	6 ^{+0.50/+0.00}	45 ^{+0.40/+0.00}	2.5	12 ±0.3	5	2.5	50	55	3.0	7.0	11.7	17.5	23.8	32.5	0.17
AC-P 30 x 80	RE020222	18	6 ^{+0.50/+0.00}	45 ^{+0.40/+0.00}	2.5	12 ±0.3	5	2.5	80	85	4.8	11.2	18.9	28.0	38.2	52.0	0.31
AC-P 40 x 40	RE020225	27	8 ^{+0.50/+0.00}	62 ^{+0.50/+0.00}	2.5	20 ±0.4	6	3	40	45	4.7	10.2	16.5	25.6	37.6	54.2	0.25
AC-P 40 x 60	RE020226	27	8 ^{+0.50/+0.00}	62 ^{+0.50/+0.00}	2.5	20 ±0.4	6	3	60	65	6.8	15.3	24.8	38.4	56.4	81.3	0.37
AC-P 40 x 100	RE020227	27	8 ^{+0.50/+0.00}	62 ^{+0.50/+0.00}	2.5	20 ±0.4	6	3	100	105	11.8	25.5	41.2	64.0	94.0	135.5	0.62
AC-P 50 x 60	RE020230	38	10 ^{+0.50/+0.00}	80 ^{+0.60/+0.00}	5	25 ±0.4	7	3.5	60	70	12.4	29.0	48.2	74.0	107.5	153.5	0.67
AC-P 50 x 80	RE020231	38	10 ^{+0.50/+0.00}	80 ^{+0.60/+0.00}	5	25 ±0.4	7	3.5	80	90	16.5	38.7	64.3	98.7	143.4	204.7	0.88
AC-P 50 x 120	RE020232	38	10 ^{+0.50/+0.00}	80 ^{+0.60/+0.00}	5	25 ±0.4	7	3.5	120	130	24.7	58.0	96.4	148.0	215.0	307.0	1.31
AC-P 60 x 80	RE020235	45	12 ^{+0.50/+0.00}	95 ^{+0.80/+0.00}	5	35 ±0.5	8	4	80	90	26.4	60.0	98.6	152.4	210.5	302.0	1.29
AC-P 60 x 100	RE020236	45	12 ^{+0.50/+0.00}	95 ^{+0.80/+0.00}	5	35 ±0.5	8	4	100	110	33.0	75.0	123.2	190.5	263.1	377.5	1.54
AC-P 60 x 150	RE020237	45	12 ^{+0.50/+0.00}	95 ^{+0.80/+0.00}	5	35 ±0.5	8	4	150	160	49.5	112.5	184.8	285.8	394.6	566.3	2.32
AC-P 70 x 120	RE020240	50	M12x40	108 ^{+1.00/+0.00}	5	40 ±0.5	8	4	120	130	50.0	121.0	225.0	356.0	513.0	741.0	2.42
AC-P 70 x 200	RE020241	50	M12x40	108 ^{+1.00/+0.00}	5	40 ±0.5	8	4	200	210	100.0	237.0	428.0	670.0	963.0	1378.0	4.11
AC-P 70 x 300	RE020242	50	M12x40	108 ^{+1.00/+0.00}	5	40 ±0.5	8	4	300	310	147.0	350.0	630.0	990.0	1431.0	2052.0	6.32

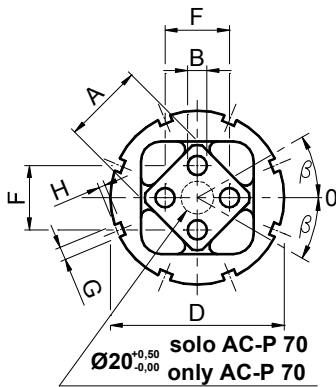
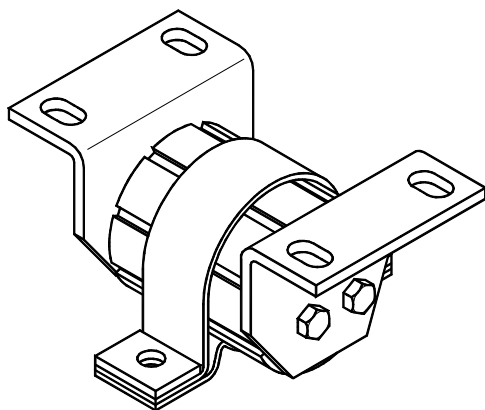

材料

外壳和内部方管为铝制拉丝。

处理

外壳为烤炉涂漆，内管由 RAL 涂漆覆盖。

固定

在中心轴以螺钉固定，以保证稳固不移动的安装。安装也可使用 **SB** 和 **SY** 型的夹具。外壳的固定可使用 **SC** 型的夹具。外壳上的槽便于使用侧面孔钩扳手将弹性组件预加负荷。

MATERIALS

The external body and the inner square are made of light alloy profile.

TREATMENTS

The external body is oven-painted while the inner square is covered with a RAL varnish.

FITTING

The central pin is fixed with screws for more stable and safe assembly. For the assembling operation, SB and SY-type brackets can also be used. The external element can be fixed with the SC clamps. The grooves on the outer body help pre-load the elastic element by means of a sector key.

型号 AC-P 配 SC 和 SB 夹具

Type AC-P with SC and SB clamps