

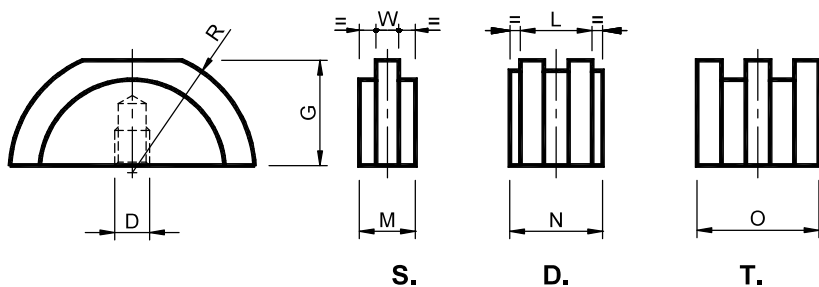

张紧装置配套元件 / KIT for chain tighteners

聚乙烯滑块 – 型号: L / Polyethylene sliding block – Type: L



轮廓的形状如此设计使得与工作表面接触的始终有两 / 三个链条滚轮 (图 1)。这种解决办法以圆满经济的方式代替具大半径滑动轮廓的大型滑块。

 The profile shape has been created so that there are always two/three chain rollers in contact with the work surface (fig.1). This solution is an effective and inexpensive alternative to using large sliders with extensive sliding profile ranges.





图 1

 材料 高分子密度聚乙烯滑块。

应用 具半圆形轮廓顶部磨平的滑块

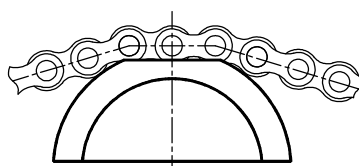
适用于大轴距。

工作速度 ≤ 20 米 / 分。

工作温度 $\leq 70^\circ\text{C}$ 。

 MATERIALS Sliding block made of polyethylene, high molecular density.

USE Semi-circular lowered profile, suitable for large interaxis. Operating speed ≤ 20 m/min. Operating temperature $\leq 70^\circ\text{C}$.

型号 Type	S 编号 N°	D 编号 N°	T 编号 N°	链条 Chain	G	R	W	M	N	O	L	D	重量 Weight in Kg		
													S.	D.	T.
L10-0	TB001097	TB001107		8mm	30	35	2.5	18	18	/	8	M10	0.03	0.03	0.05
L10-1	TB001098	TB001108	TB001117	3/8" x 7/32"	30	35	5	18	18	25	15	M10	0.03	0.03	0.05
L20-1	TB001098	TB001108	TB001117	3/8" x 7/32"	30	35	5	18	18	25	15	M10	0.03	0.03	0.05
L10-2	TB001099	TB001109	TB001118	1/2" x 5/16"	30	35	7	18	21	34	20	M10	0.03	0.04	0.06
L20-2	TB001099	TB001109	TB001118	1/2" x 5/16"	30	35	7	18	21	34	20	M10	0.03	0.04	0.06
L30-2	TB001099	TB001109	TB001118	1/2" x 5/16"	30	35	7	18	21	34	20	M10	0.03	0.04	0.26
L30-3	TB001100	TB001110	TB001119	5/8" x 3/8"	37	45	9	18	25	42	25	M10	0.04	0.06	0.11
L40-3	TB001100	TB001110	TB001119	5/8" x 3/8"	37	45	9	18	25	42	25	M10	0.04	0.06	0.11
L30-4	TB001101	TB001111	TB001120	3/4" x 7/16"	37	45	11	18	30	49	30	M10	0.04	0.07	0.13
L40-4	TB001101	TB001111	TB001120	3/4" x 7/16"	37	45	11	18	30	49	30	M10	0.04	0.07	0.13
L40-5	TB001102	TB001112	TB001121	1" x 17.02mm	46	55	16	20	47	79	47	M10	0.08	0.17	0.30
L50-5	TB001102	TB001112	TB001121	1" x 17.02mm	46	55	16	20	47	79	47	M10	0.08	0.17	0.30
L50-6	TB001103			1"1/4 x 3/4"	46	55	18	22	/	/	/	M10	0.08	0.19	0.34
L50-7	TB001104			1"1/2 x 1"	46	55	24	24	/	/	/	M10	0.11	0.21	0.35

应用实例 / Application example

