

链条张紧装置配套元件 / KIT for chain tighteners

具国产轴承在支架上的钢制链轮 – 型号: **NA**
Sprocket made of steel on the fork with national bearing – Type: NA

具 INA 轴承在支架上的链轮 – 型号: **IA**
Sprocket made of steel on the fork with INA bearing – Type: IA

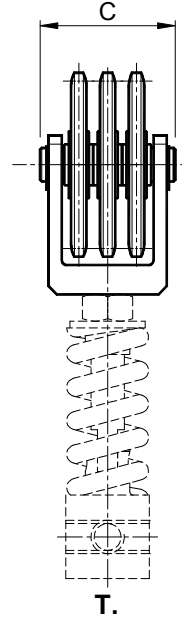
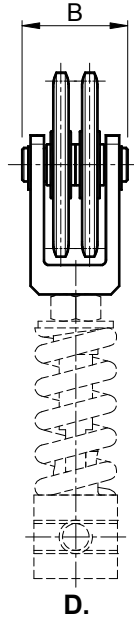
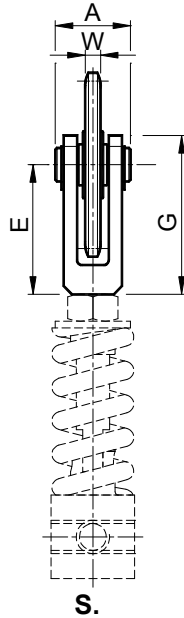
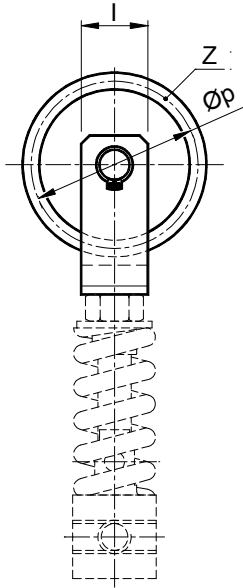

材料 支架为铝制或钢制。轴承、冠和中心轴为钢制。
处理 铝制支架喷砂，钢制支架涂漆。冠和中心轴为镀锌钢。
应用 链轮由一个安装在底部放大的轴承上的钢冠组成。轴承为国产轴承 (NA) 或 INA 轴承 (IA)。
 工作速度 ≤ 60 米 / 分。工作温度 ≤ 100°C。

MATERIALS The fork is made of aluminium or steel. The ball bearing, the crown and the pin are made of steel.
TREATMENTS Fork made of sandblasted aluminium or painted steel. The crown and the pin are made of galvanized steel.
USE Idle pin on the fork. The sprocket consists of a steel crown, installed on national (type NA) or INA (type IA) enlarged bearings.
 Operating speed ≤ 60 m/min.
 Operating temperature ≤ 100°C.

NA: 链条张紧装置链轮
 (具国产轴承)
 NA: Sprocket wheel set
 (with national bearing)

IA: 链条张紧装置链轮
 (具 INA 轴承)
 IA: Sprocket wheel set
 (with INA bearing)

型号 Type	S 编号 N°	D 编号 N°	T 编号 N°	链条 Chain	型号 Type	S 编号 N°	D 编号 N°	T 编号 N°	R _c Size	A	B	C	Øp	E	G	I	Z	W	重量 Weight in Kg		
																			S.	D.	T.
NA 20-1	AR070943	AR070970		3/8" x 7/32"	IA 20-1	AR071021	AR071048		20	40	60		63.90	60	75	30	21	5.3	0.29	0.52	
NA 30-1	AR070943	AR070970	AR070996	3/8" x 7/32"	IA 30-1	AR071021	AR071048	AR071074	30	40	60	60	63.90	60	75	30	21	5.3	0.29	0.52	0.78
NA 30-2	AR070946	AR070973		1/2" x 5/16"	IA 30-2	AR071024	AR071051		30	40	60		73.14	60	75	30	18	7.2	0.36	0.65	
NA 40-2			AR070998	1/2" x 5/16"	IA 40-2			AR071076	40			60	73.14	60	75	30	18	7.2			1.25
NA 30-3	AR070948	AR070975		5/8" x 3/8"	IA 30-3	AR071026	AR071053		30	45	65		86.39	70	85	30	17	9.1	0.51	0.96	
NA 40-3	AR070949	AR070976	AR071000	5/8" x 3/8"	IA 40-3	AR071027	AR071054	AR071078	40	45	65	78	86.39	70	85	30	17	9.1	0.51	0.96	
NA 50-3			AR071001	5/8" x 3/8"	IA 50-3			AR071079	50			78	86.39	70	85	30	17	9.1			1.97
NA 30-4	AR070951			3/4" x 7/16"	IA 30-4	AR071029			30	45			91.63	70	85	30	15	11.1	0.57		
NA 40-4	AR070952	AR070978	AR071003	3/4" x 7/16"	IA 40-4	AR071030	AR071056	AR071081	40	45	65	78	91.63	70	85	30	15	11.1	0.57	1.14	3.10
NA 50-4	AR070953	AR070979	AR071004	3/4" x 7/16"	IA 50-4	AR071031	AR071057	AR071082	50	45	65	78	91.63	70	85	30	15	11.1	0.57	1.14	3.10
NA 40-5	AR070955	AR070981		1" x 17.02	IA 40-5	AR071033	AR071059		40	45	78		98.14	77.5	95	40	12	16.2	0.97	2.10	
NA 50-5	AR070956	AR070982	AR071006	1" x 17.02	IA 50-5	AR071034	AR071060	AR071084	50	45	78	115	98.14	77.5	95	40	12	16.2	0.97	2.10	4.86
NA 60-5			AR071007	1" x 17.02	IA 60-5			AR071085	60			115	98.14	77.5	95	40	12	16.2			4.86
NA 60-6	AR070958	AR070984	AR071009	1 1/4" x 3/4"	IA 60-6	AR071036	AR071062	AR071087	60	60	115	130	132.65	105	125	50	13	18.5	2.80	5.10	6.88
NA 60-7	AR070960	AR070986	AR071011	1 1/2" x 1"	IA 60-7	AR071038	AR071064	AR071089	60	60	115	130	135.21	105	125	50	11	24.1	3.20	5.93	8.97