

**4 lobe knob (reinforced type) - Part. D46**  
**Volantino a 4 lobi (tipo rinforzato) - Part. D46**

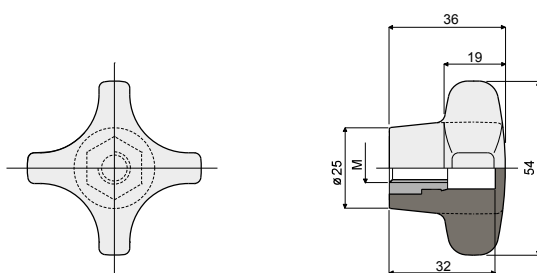

Type/Tipo	Code/Codice	M
D46A	CPA00267	M8
D46	CP000267	M10
D46B	CPA00268	M12

**MATERIALS:** Knob made of reinforced polyamide black colour; threaded bushing made of nickel plated brass.

**FEATURES:** Accessory to be used with heads Part.D21 and D66.

**MATERIALI:** Volantino in poliammide rinforzata colore nero; boccola filettata in ottone nichelato.

**CARATTERISTICHE:** Accessorio da applicare alle testine Part. D21 e D66.

**4 lobe knob (reinforced type) - Part. D47**  
**Volantino a 4 lobi (tipo rinforzato) - Part. D47**

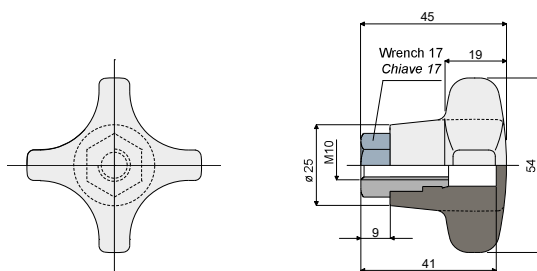

Type/Tipo	Code/Codice
D47	CP000268

**MATERIALS:** Knob made of reinforced polyamide black colour; threaded bushing made of nickel plated brass.

**FEATURES:** Accessory to be used with heads Part.D21 and D66.

**MATERIALI:** Volantino in poliammide rinforzata colore nero; boccola filettata in ottone nichelato.

**CARATTERISTICHE:** Accessorio da applicare alle testine Part. D21 e D66.

**4 lobe knob (reinforced type) - Part. D48**  
**Volantino a 4 lobi (tipo rinforzato) - Part. D48**

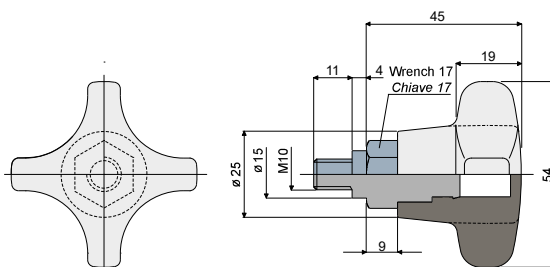

Type/Tipo	Code/Codice
D48	CP000269

**MATERIALS:** Knob made of reinforced polyamide black colour; threaded bushing made of nickel plated brass.

**FEATURES:** Accessory to be used with heads Part.D23.

**MATERIALI:** Volantino in poliammide rinforzata colore nero; boccola filettata in ottone nichelato.

**CARATTERISTICHE:** Accessorio da applicare alle testine Part. D23.