

**Roller for transfer plates (for Part. D57, D58, D59, D60, D61, D62, Q16, Q17, Q30, Q31, Q32, Q33) - Part. T88**

**Rullino per moduli di trasferimento (per Part. D57, D58, D59, D60, D61, D62, Q16, Q17, Q30, Q31, Q32, Q33) - Part. T88**

Application example  
Esempio di applicazione

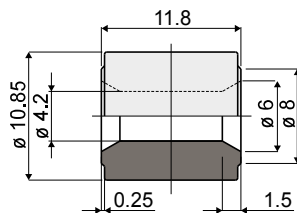
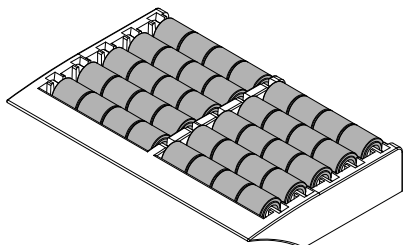

Type/Tipo	Code/Codice
T88	CPB00566

**MATERIALS:** Roller made of polyethylene, grey colour.

**MATERIALI:** Rullino in polietilene colore grigio.

**Roller for roller guide ( for Part. T06, T07, T08, T19, T45, Q23, Q48, Q51) - Part. T93**

**Rullino per guide prpodotto (per Part. T06, T07, T08, T19, T45, Q23, Q48, Q51) - Part. T93**

Application example  
Esempio di applicazione

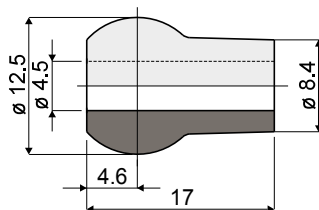
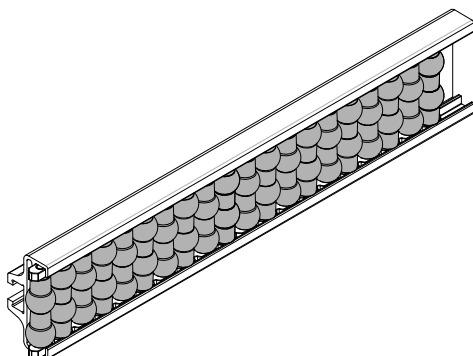

Type/Tipo	Code/Codice
T93	CPB00567

**MATERIALS:** Roller made of polyethylene, grey colour.

**MATERIALI:** Rullino in polietilene colore grigio.

**Roller for roller guides (for Part. T44, T55, T56, T57, T58, Q21, Q50, Q53) - Part. T94**

**Rullino per guide prpodotto (per Part. T44, T55, T56, T57, T58, Q21, Q50, Q53) - Part. T94**

Application example  
Esempio di applicazione

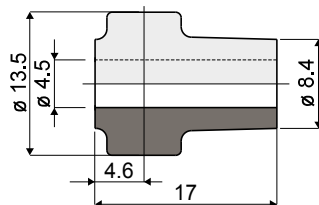
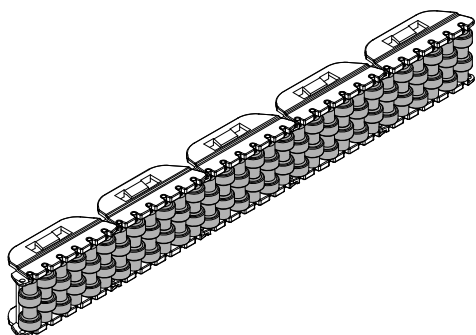

Type/Tipo	Code/Codice
T94	CPB00568

**MATERIALS:** Roller made of polyethylene, grey colour.

**MATERIALI:** Rullino in polietilene colore grigio.