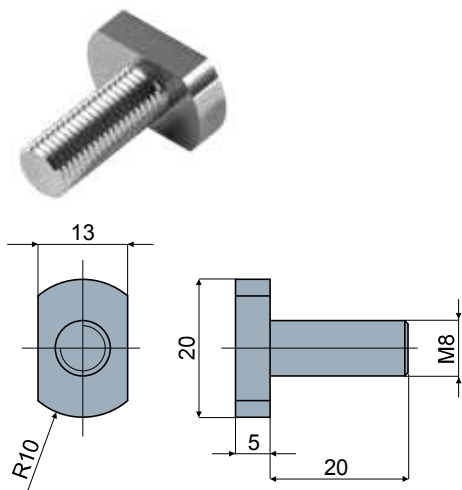

Screw with shaped head (hammer head) - Part. Q37

Vite con testa sagomata (a martello) - Part. Q37

Type/Tipo

Q37

Code/Codice

CPB00498

 **MATERIALS:** Screw in zinc-plated steel.

FEATURES: To be used with guides Part. T06, T07, T08, T19, Q68, Q74, Q75, Q76, T25, T26, T27, T28, Q67, Q77, Q78, Q79, T55, T56, T57, T58, Q64, Q80, T20, T21, T22, T23, T81, T84.

 **MATERIALI:** Vite in acciaio zincato.

CARATTERISTICHE: Da utilizzare nelle guide Part. T06, T07, T08, T19, Q68, Q74, Q75, Q76, T25, T26, T27, T28, Q67, Q77, Q78, Q79, T55, T56, T57, T58, Q64, Q80, T20, T21, T22, T23, T81, T84.

Application example Esempio di applicazione

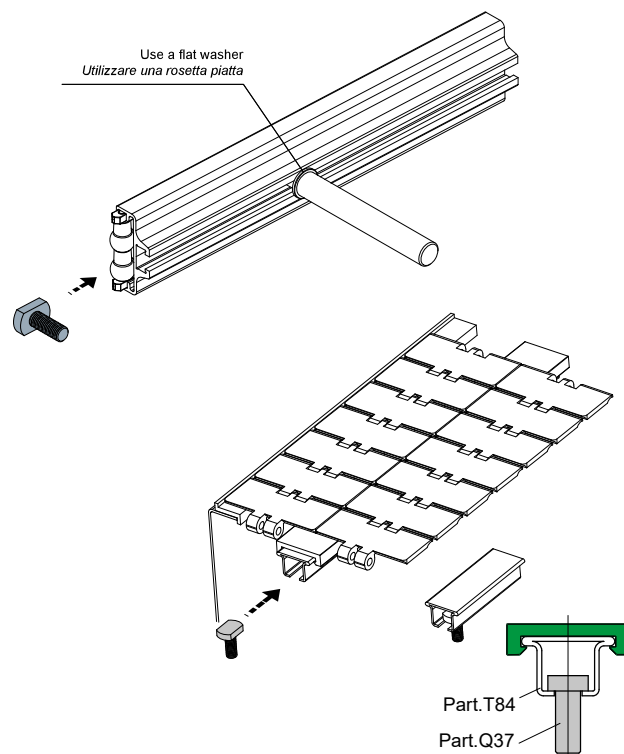

Slot closing profile - Part. C22

Profilo di chiusura cava - Part. C22

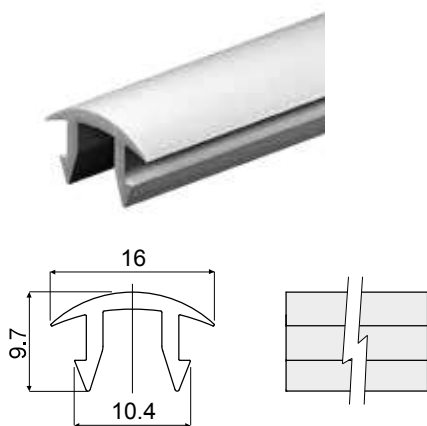
Type/Tipo

C22

Code/Codice

CPB00499

 **MATERIALS:** Profile made of soft PVC grey colour.

FEATURES: To be used with guides Part. T06, T07, T08, T19, Q68, Q74, Q75, Q76, T25, T26, T27, T28, Q67, Q77, Q78, Q79, T55, T56, T57, T58, Q64, Q80, T20, T21, T22, T23, T81, T84. Pressure mounting.

 **MATERIALI:** Profilo di chiusura cava in PVC morbido colore grigio.

CARATTERISTICHE: Da utilizzare con i Part. T06, T07, T08, T19, Q68, Q74, Q75, Q76, T25, T26, T27, T28, Q67, Q77, Q78, Q79, T55, T56, T57, T58, Q64, Q80, T20, T21, T22, T23, T81, T84. Montaggio a pressione.

Application example Esempio di applicazione

