

**Guide profile (metallic profile) - Part. Q82**  
**Profilo guida prodotto (profilo metallico) - Part. Q82**

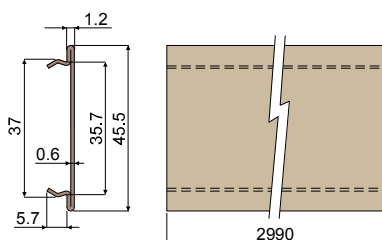

**Application example**  
**Esempio di applicazione**

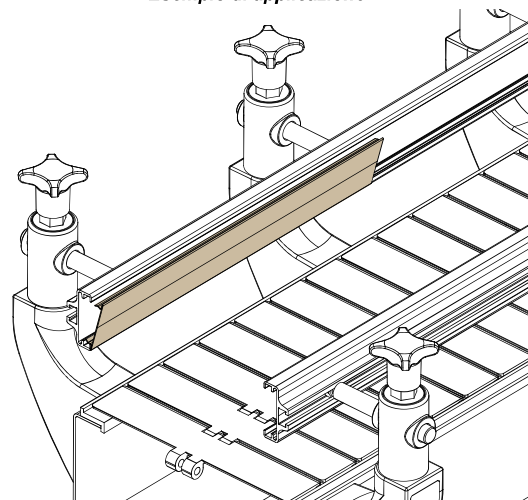

Type/Tipo	Code/Codice
Q82	CPB00489

**UK MATERIALS:** Guide profile in stainless steel AISI 304 covered with peek. **FEATURES:** Suitable for use with bundles covered with shrink-wrapped polyethylene film. The coating with peek guarantees maximum smoothness of the product. Suitable for high temperatures applications. Peek covering thickness: min. 40 μ, max 50 μ. Supplied in bars of 2.99 meters length. Snap-on assembly on profiles: Part.T20, T22.

**IT MATERIALI:** Guida in acciaio inox AISI 304 con rivestimento in peek. **CARATTERISTICHE:** Indicato per l'utilizzo con fardelli rivestiti in film di polietilene termoretraibile. Il rivestimento in peek garantisce la massima scorrevolezza del prodotto. Indicato per applicazioni ad alte temperature. Spessore del rivestimento: min. 40 μ, max 50 μ. Fornito in barre da 2990 mm. Montaggio a scatto sui profili Part. T20, T22.

**Connecting element (for Part. Q64, Q80) - Part. Q66**  
**Giunzione intermedia (per Part. Q64, Q80) - Part. Q66**

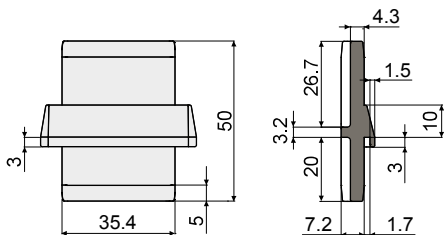
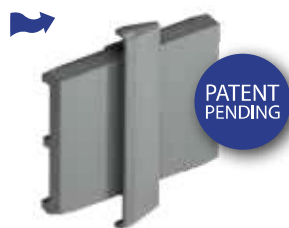

**Application example**  
**Esempio di applicazione**

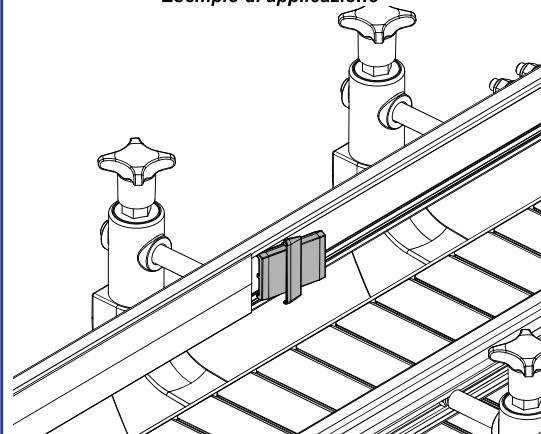

Type/Tipo	Code/Codice
Q66	CPB00490

**UK MATERIALS:** Connecting element in grey colour polyamide and auto-lubricating additive. **FEATURES:** To be used as a connecting element between the guides: Part.Q64, Q80. The self-lubricating additive guarantees maximum smoothness of the product.

**IT MATERIALI:** Giunzione in PA + additivo autolubrificante colore grigio. **CARATTERISTICHE:** Da impiegare come elemento di raccordo all'estremità delle guide Part.Q64, Q80. L'additivo autolubrificante garantisce la massima scorrevolezza del prodotto.

**Connecting element (for Part. Q64, Q80) - Part. Q65**  
**Giunzione intermedia (per Part. Q64, Q80) - Part. Q65**

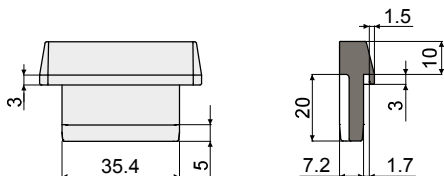
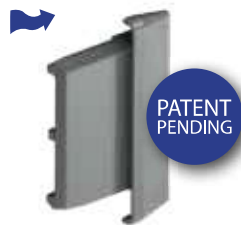

**Application example**  
**Esempio di applicazione**

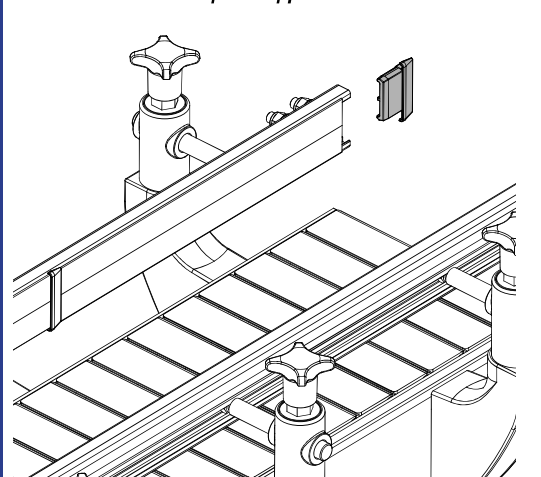

Type/Tipo	Code/Codice
Q65	CPB00491

**UK MATERIALS:** Cap in grey colour polyamide and auto-lubricating additive. **FEATURES:** To be used as a closure cap at the extremities of the guides: Part.Q64, Q80. The self-lubricating additive guarantees maximum smoothness of the product.

**IT MATERIALI:** Terminale in PA + additivo autolubrificante colore grigio. **CARATTERISTICHE:** Da impiegare come terminale di chiusura all'estremità delle guide Part. Q64, Q80. L'additivo autolubrificante garantisce la massima scorrevolezza del prodotto.

Suitable for applications which require maximum smoothness. *Indicato per applicazioni che richiedono la massima scorrevolezza.*

Suitable for use with bundles covered with shrink-wrapped polyethylene film. *Indicato per l'utilizzo con fardelli rivestiti in film di polietilene termoretraibile.*

Suitable for high temperatures applications. *Indicato per applicazioni ad alte temperature.*