

Flange for chain guide (for rollers Part. D51, D52, D53, D45, D93, D50, D49, T99, C25) - Part. D54
Flangia guidacatena (per rullini Part. D51, D52, D53, D45, D93, D50, D49, T99, C25) - Part. D54

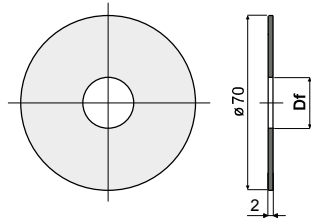

Type Tipo	Code Codice	Df Bore for pin of Foro per perno da (mm)
D54A	CP000446	12
D54B	CP000447	14
D54C	CP000448	15
D54E	CP000449	16
D54F	CP000450	18
D54G	CP000451	20

UK MATERIALS: Flange is made of polypropylene black colour. **FEATURES:** To be assembled to our roller for chain return Part.D51, D52, D53, D45, D93, D50, D49, T99, C25.

IT MATERIALI: Flangia in polipropilene colore nero. **CARATTERISTICHE:** Da utilizzare con i rullini Part.D51, D52, D53, D45, D93, D50, D49, T99, C25.

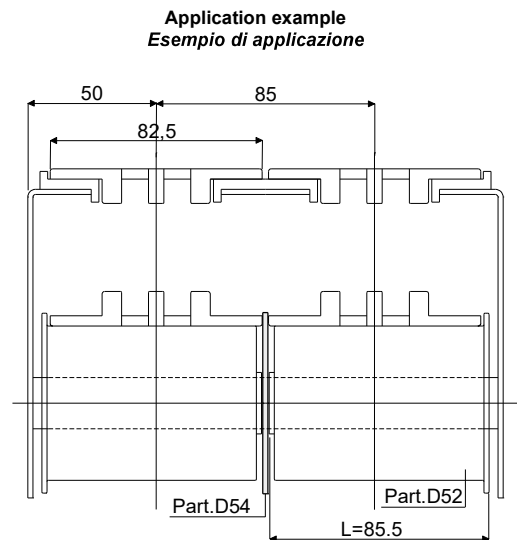

Flange for chain guide (for rollers Part. D51, D52, D53, D45, D93, D50, D49, T99, C25) - Part. C24
Flangia guidacatena (per rullini Part. D51, D52, D53, D45, D93, D50, D49, T99, C25) - Part. C24

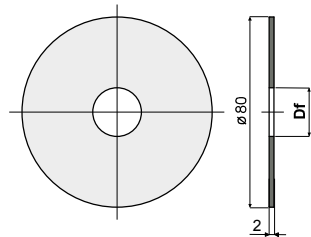

Type Tipo	Code Codice	Df Bore for pin of Foro per perno da (mm)
C24A	CPA00446	12
C24B	CPA00447	16
C24C	CPA00448	20

UK MATERIALS: Flange is made of polypropylene black colour. **FEATURES:** To be assembled to our roller for chain return Part.D51, D52, D53, D45, D93, D50, D49, T99, C25.

IT MATERIALI: Flangia in polipropilene colore nero. **CARATTERISTICHE:** Da utilizzare con i rullini Part.D51, D52, D53, D45, D93, D50, D49, T99, C25.

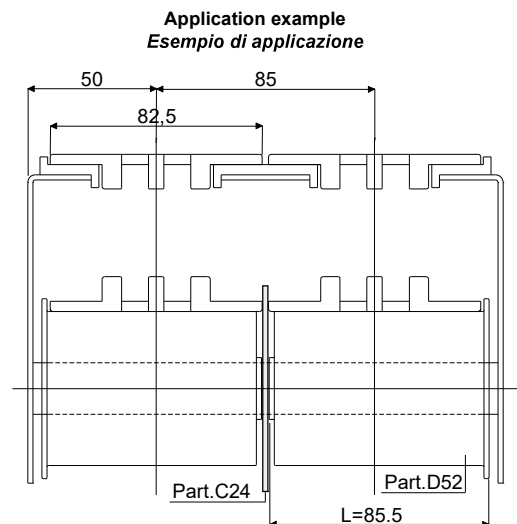

Flange for chain guide (for rollers Part. D76, D71, D70) - Part. D82
Flangia guidacatena (per rullini Part. D76, D71, D70) - Part. D82

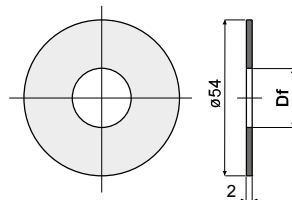

Type Tipo	Code Codice	Df Bore for pin of Foro per perno da (mm)
D82A	CP000452	15
D82B	CP000453	16
D82C	CP000454	18
D82E	CP000455	20

UK MATERIALS: Flange is made of polypropylene black colour. **FEATURES:** To be assembled to our roller for chain return Part.D76, D71, D70.

IT MATERIALI: Flangia in polipropilene colore nero. **CARATTERISTICHE:** Da utilizzare con i rullini Part.D76, D71, D70.

