

Spacer for rollers for chain return - Part. D75
Distanziale per rullini ritorno catene - Part. D75

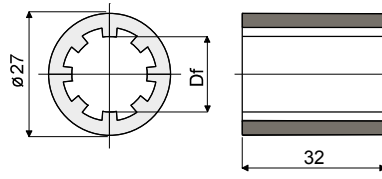
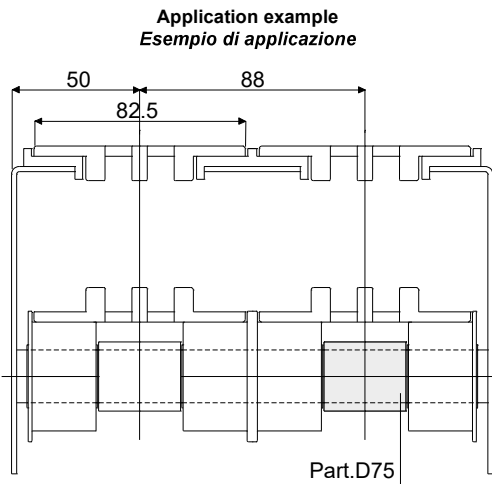

Type/Tipo	Code/Codice	Df Bore for pin of Foro per perno da (mm)
D75A	CP000408	12
D75B	CP000409	16
D75C	CP000410	18
D75D	CP000411	20

MATERIALS: Spacer made of polyamide black colour.
FEATURES: To be assembled in the chain return.

MATERIALI: Distanziale in poliammide colore nero.
CARATTERISTICHE: Da utilizzare come distanziale tra i rullini.

Spacer for rollers for chain return - Part. D72
Distanziale per rullini ritorno catene - Part. D72

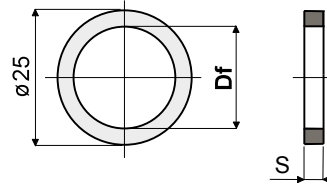
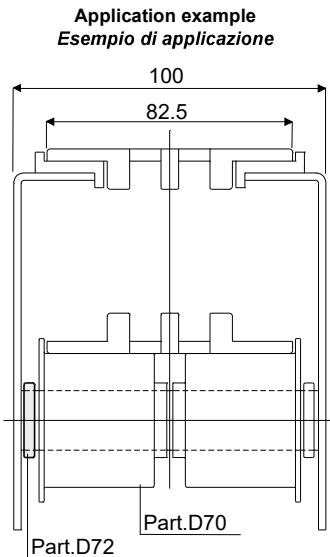

Type/Tipo	Code/Codice	Df Bore for pin of Foro per perno da (mm)	S
D72A	CP000412	15	3,5
D72C	CPA00412	16	3,5
D72D	CPA00413	16	5
D72B	CP000413	20	3,5
D72E	CPB00412	20	5

MATERIALS: Spacer made of polyamide black colour.
FEATURES: To be assembled in the chain return.

MATERIALI: Distanziale in poliammide colore nero.
CARATTERISTICHE: Da utilizzare come distanziale tra i rullini.

Spacer for rollers for chain return - Part. C20
Distanziale per rullini ritorno catene - Part. C20

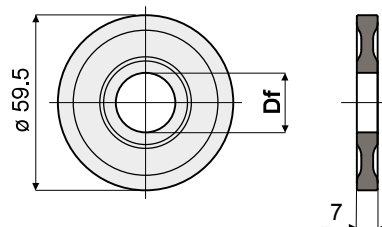
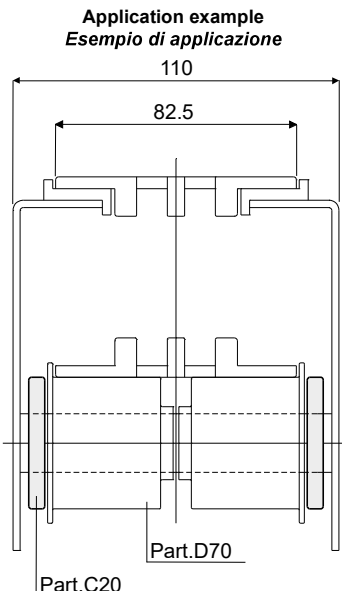

Type/Tipo	Code/Codice	Df Bore for pin of Foro per perno da (mm)
C20	CPB00413	12

MATERIALS: Spacer made of polyamide black colour.
FEATURES: To be assembled in the chain return.

MATERIALI: Distanziale in poliammide colore nero.
CARATTERISTICHE: Da utilizzare come distanziale tra i rullini.