

**PIGNONI TENDICATENA - Tipo: PTC / CHAIN TENSIONER PINIONS - Type: PTC**

**MATERIALI** Acciaio

**TRATTAMENTI** Corona con trattamento di zincatura.

**IMPIEGO** Il pignone è costituito da una corona in acciaio, montata su cuscinetti nazionali a base maggiorata. A richiesta si possono fornire con cuscinetti INA. Sono utilizzati per tensionamenti manuali o per la realizzazione di rinvi.

**MATERIALS** Steel

**TREATMENTS** The crown wheel is zinc plated

**USE** The sprocket consists of a steel crown, installed on enlarged bearings. On demand we can supply the sprocket with INA bearing.

They are used for manual chain tensioning or for the realization of gear transmissions.

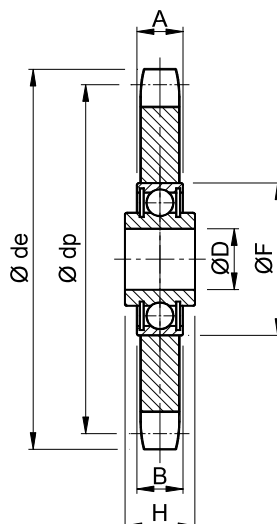

Tipo Type	Cod. N°	Catena Chain	Z	Ø de	Ø dp	A	B	Ø D	Ø F	H	Peso Weight in kg
PTC 1-21	TB001195	3/8" x 7/32"	21	68.0	63.90	5.3	12	16 <sup>+0.26 +0.13</sup>	40	18.3	0.17
PTC 2-14	TB001216	1/2" x 5/16"	14	61.9	57.07	7.2	12	16 <sup>+0.26 +0.13</sup>	40	18.3	0.15
PTC 2-15	TB001205	1/2" x 5/16"	15	66.8	61.09	7.2	12	16 <sup>+0.26 +0.13</sup>	40	18.3	0.16
PTC 2-16	TB001196	1/2" x 5/16"	16	69.5	65.10	7.2	12	16 <sup>+0.26 +0.13</sup>	40	18.3	0.18
PTC 2-17	TB001175	1/2" x 5/16"	17	74.0	69.11	7.2	12	16 <sup>+0.26 +0.13</sup>	40	18.3	0.21
PTC 2-18	TB001197	1/2" x 5/16"	18	77.8	73.14	7.2	12	16 <sup>+0.26 +0.13</sup>	40	18.3	0.23
PTC 3-14	TB001198	5/8" x 3/8"	14	78.0	71.34	9.1	12	16 <sup>+0.26 +0.13</sup>	40	18.3	0.24
PTC 3-15	TB001215	5/8" x 3/8"	15	83.0	76.36	9.1	12	16 <sup>+0.26 +0.13</sup>	40	18.3	0.28
PTC 3-16	TB001176	5/8" x 3/8"	16	88.3	81.37	9.1	12	16 <sup>+0.26 +0.13</sup>	40	18.3	0.34
PTC 3-17	TB001199	5/8" x 3/8"	17	93.0	86.39	9.1	12	16 <sup>+0.26 +0.13</sup>	40	18.3	0.36
PTC 4-13	TB001204	3/4" x 7/16"	13	87.5	79.59	11.1	12	16 <sup>+0.26 +0.13</sup>	40	18.3	0.42
PTC 4-14	TB001177	3/4" x 7/16"	14	93.8	85.61	11.1	12	16 <sup>+0.26 +0.13</sup>	40	18.3	0.44
PTC 4-15	TB001200	3/4" x 7/16"	15	99.8	91.63	11.1	12	16 <sup>+0.26 +0.13</sup>	40	18.3	0.46
PTC 5-12	TB001201	1" x 17.02mm	12	109.0	98.14	16.2	14	20 <sup>+0.10 -0.00</sup>	47	17.7	0.74
PTC 6-13	TB001202	1"1/4 x 3/4"	13	147.8	132.65	18.5	15	25 <sup>+0.00 -0.01</sup>	52	21.0	1.60
PTC 7-11/20	TB001203	1"1/2 x 1"	11	149.0	135.21	24.1	30.0	20 <sup>+0.00 -0.01</sup>	52	30.0	2.07
PTC 7-11/25	TBA01203	1"1/2 x 1"	11	149.0	135.21	24.1	30.0	25 <sup>+0.00 -0.01</sup>	52	30.0	2.09



**CUSCINETTI A SFERA / BALL BEARING**

Tipo Type	Cod. N°	d	D	A	B	Peso Weight in kg
203 KRR AH 02	BU008530	16 <sup>+0.13 +0.26</sup>	40	12	18.3	0.082
204 KRR	BU008531	20 <sup>+0.10 -0.00</sup>	47	14	17.7	0.115
205 KRR	BU008534	25 <sup>+0.00 -0.01</sup>	52	15	21.0	0.149

